

Cage Code: 704Q7

RevNo	Revision note	Date	Signature	Checked
-------	---------------	------	-----------	---------

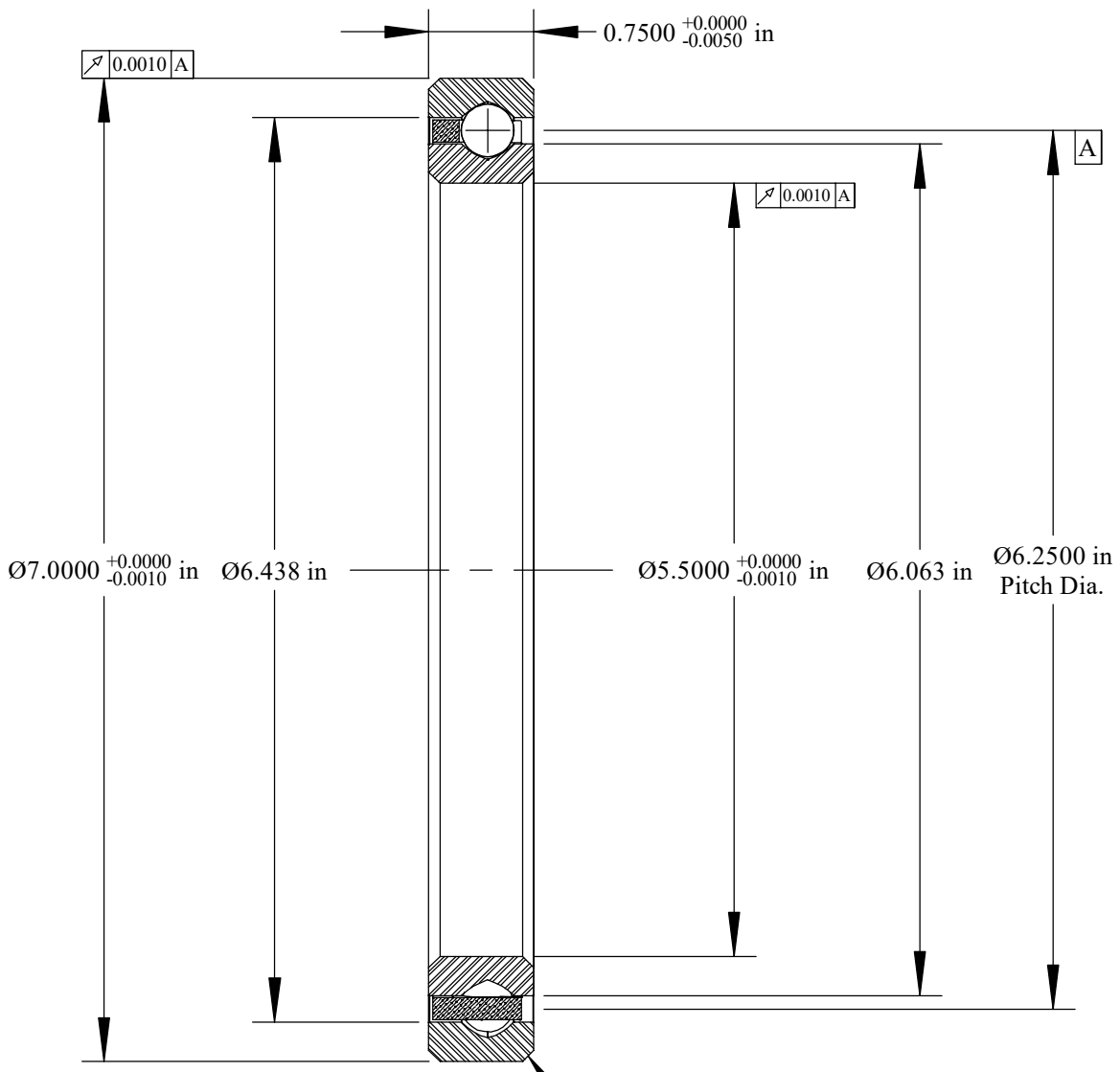

Scale: 0.8:1  
 Will Clear 0.080  
 Max. Fillet Radius  
 4 Exterior Corners

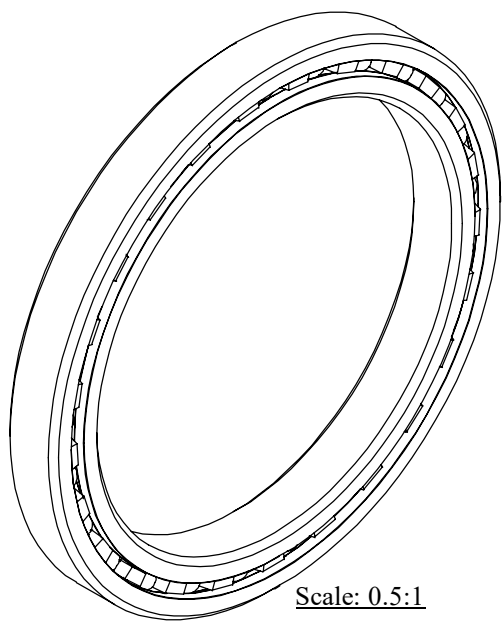

Scale: 0.5:1

	OUTER	INNER	SEPARATOR	BALL
MATERIAL	52100	52100	BRASS	52100
HARDNESS	Rc 59-62	Rc 59-62		
RACE RUN-OUT	OUTER	INNER		
ABEC RATING	PRELOAD		ROLLING ELEMENT	
1	N/A		QUANTITY	SIZE
			25	3/8
RADIAL LOAD	THRUST LOAD		MOMENT LOAD	
DYNAMIC: 5415 Lbs. STATIC: 7050 Lbs.	DYNAMIC: 8200 Lbs. STATIC: 17,630 Lbs.		DYNAMIC: 12,696 Lbs.-in. STATIC: 22,040 Lbs.-in.	
RADIAL PLAY	CONTACT ANGLE		LIMITING SPEED	
0.0020 0.0030	N/A		700 RPM	
LUBRICATION	SEAL		BEARING WEIGHT	
LIGHT OIL PRESERVATIVE	N/A		2.50 Lbs.	

UNLESS OTHERWISE SPECIFIED ALL DIMENSIONS IN INCHES

**SSB**  
thin section bearings

Corporate Headquarters  
 15151 Prater Drive  
 Covington, GA 30014  
 (800) 431-1980  
 www.rfbearing.com

Designed by ML	Checked by ML	This drawing and the information contained herein are proprietary and the property of Ribearing Corporation.	
<b>RF055XP0</b>		Four Point Contact Thin Section Ball Bearing	
File name RF055XP0	Date March 20,2020	REVISION A	Sheet 1 of 1